

Free Mod Service Or Assemble It Yourself!

Quick shipment is standard on all LEESON IRONMAN BY OHIO GEAR™ stock and modified stock gear reducers. Order the assembly you require from the catalogue or order parts from those listed on the following pages to assemble it yourself.

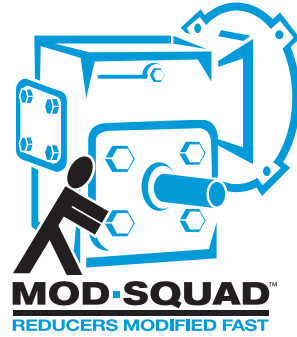

Before ordering, check the dimensional data available with this catalogue.

Style T or U Horizontal Base



Series	Kit Only Catalog No.	Washguard Kit Only Catalog No.	Weight (lbs)
813	G185000	G185045	3
815	G185120	G185180	3
818	G185005	G185046	3
821	16463	16463W	3
824	G185015	G185048	8
826	G185020	G185049	10
830	G185121	G185181	16
832	G185025	G185182	16
842	G185030	-	18
852	G185035	-	22
8600	G185040	-	31



Style J Vertical Input Base

Series	Kit Only Catalog No.	Washguard Kit Only Catalog No.	Weight (lbs)
813	G185001	G185054	1
815	G185122	G185183	2
818	G185006	G185055	2
821	16483	16483W	3
824	G185016	G185057	3
826	G185021	G185058	4
830	G185123	G185184	6
832	G185124	G185185	6
842	G185125	-	11
852	G185126	-	18

Style VL or VH Vertical Output Shaft Base



Series	Kit Only Catalog No.	Washguard Kit Only Catalog No.	Weight (lbs)
813	G185002	G185063	4
815	G185127	G185186	4
818	G185007	G185064	4
821	16473	16473W	8
824	G185017	G185066	8
826	G185022	G185067	11
830	G185128	G185187	14
832	G185027	G185188	14
842	G185032		28
852	G185037		36
8600	G185042		36



Style R Riser Block

Series	Kit Only Catalog No.	Washguard Kit Only Catalog No.	Weight (lbs)
815	G185141		7
818	G185142		7
821	16516		9
824	G185144		9
826	G185145		17
830	G185146		15
832	G185147		31
842	G185148		24
852	G185149		15

Style F Output Flange - Cast Iron



Series	Kit Only Catalog No.	Washguard Kit Only Catalog No.	Weight (lbs)
813	G185130		1
815	G185131		2
818	G185132		3
821	G185133		4
824▼	G185134		5
826▼	G185135		5
830▼	G185136		16
832▼	G185137		16
842▼	G185138		12
852▼	G185139		28
8600▼	G185140		12

▼ Flanges for sizes 824 - 860 with solid output shafts must be assembled at LEESON.



Style BF Output Flange - Steel

Series	Kit Only Catalog No.	Washguard Kit Only Catalog No.	Weight (lbs)
813	G185004	G185081	6
818	G185009	G185082	6
821	G185014	G185083	10
824	G185019	G185084	10
826	G185024	G185085	13

Dimensions for BF units are on the following page.

BM STYLE INPUT FLANGE KITS**



Series		48CZ	56C	143-5TC	182-4TC	213-5TC	254-6TC
813	Catalog No.	G185161	G185090	--	--	--	--
	Weight (lbs)	7	7	--	--	--	--
815	Catalog No.	G185162	G185163	G185164	--	--	--
	Weight (lbs)	7	7	7	--	--	--
818	Catalog No.	G185165	G185091	G185092	--	--	--
	Weight (lbs)	7	7	7	--	--	--
821	Catalog No.	G185166	G185093	G185094	--	--	--
	Weight (lbs)	7	7	7	--	--	--
824	Catalog No.	--	G185095	G185096	G185097	--	--
	Weight (lbs)	--	8	8	11	--	--
826	Catalog No.	--	G185098	G185099	G185100	--	--
	Weight (lbs)	--	8	8	11	--	--
830	Catalog No.	--	G185167	G185168	G185169	--	--
	Weight (lbs)	--	11	11	11	--	--
832	Catalog No.	--	G185101	G185102	G185103	G185170	--
	Weight (lbs)	--	11	11	11	11	--
842	Catalog No.	--	G185171	G185104	G185105	G185106	G185172
	Weight (lbs)	--	14	14	16	16	30
852	Catalog No.	--	--	G185173	G185107	G185108	G185109
	Weight (lbs)	--	--	16	18	18	30
8600	Catalog No.	--	--	--	G185174	G185110	G185111
	Weight (lbs)	--	--	--	22	22	32

** All kits include flexible coupling.

DOUBLE REDUCTION ADAPTOR KITS



Series	Accessory Kit Only Catalog #	Primary Unit Size	Secondary Unit Quill Size	Weight (lbs.)
813 - 821	G185150	813	56C	3
824	G185151	813	56C	3

REACTION ROD KITS



Series	Accessory Kit Only Catalog #	Weight (lbs.)
813 - 842	G185152	5
852 - 8600	G185153	5

BF STYLE OUTPUT FLANGE KITS

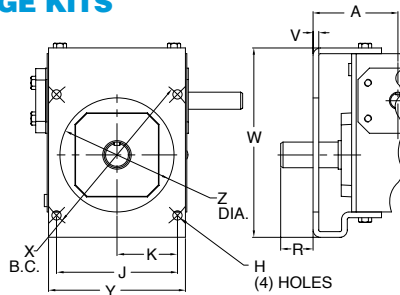

Style BF Output Flange Kits

Series	A	H	J	K	R	V	W	X	Y	Z
813	3.00	0.34	3.54	1.77	1.00	0.19	5.55	5.00	4.25	3.62
818	3.50	0.34	4.16	2.08	0.81	0.19	6.66	5.88	4.81	4.06
821	3.75	0.41	4.60	2.30	0.93	0.19	7.47	6.50	5.75	4.50
824	3.72	0.41	5.30	2.65	1.37	0.25	8.30	7.50	6.00	5.00
826	4.06	0.41	5.66	2.83	1.57	0.25	9.25	8.00	7.18	6.00

Style BF Output Flange - Steel

Series	Accessory Kit Only Catalog No.	Mod-Squad™ Service Number Style BF	Weight (lbs)
813	G185004	BF813	6
818	G185009	BF818	6
821	G185014	BF821	10
824	G185019	BF824	10
826	G185024	BF826	13

