

Free Mod-Squad™ Service Or Assemble It Yourself!

Any of the preferred stock 700 Series reducers are available on a quick shipment basis, assembled with an interchange base or output flange by the **LEESON Gear Mod-Squad**—at no charge for the labor! Just pay for the accessory item. To order, specify the basic reducer catalog number and the Mod-Squad™ suffix code. Output flanges are listed on page 137. Interchange bases are listed on pages 138-139.

Or **assemble it yourself** by ordering the appropriate basic reducer and accessory kit (see options below).

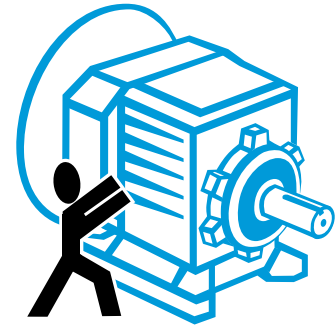

MOD-SQUAD™
IN-LINE MODIFICATIONS

START

Select
Basic Reducer
Double or Triple Reduction

CHOOSE

Base Mount

OR

Flange Mount



ADD

Torque Foot for High-Shock Applications
(Base Mount Only)



SEE MAX RATINGS PP. 128-135

SEE INTERCHANGE BASE P. 138

SEE OUTPUT FLANGE P. 137

SEE TORQUE FOOT P. 137



Motorized Quill Input



Motorized Quill Input
Base Mount



Motorized Quill Input
Flange Mount



Motorized Quill Input
Base Mount
w/Torque Foot



Non-Motorized Input



Non-Motorized Input
Base Mount



Non-Motorized Input
Flange Mount



Non-Motorized Input
Base Mount
w/Torque Foot

717 Series • Flange Mount • Mod-Squad Codes Accessory Kits

| Output Flange Options: | Mod-Squad Suffix Code (XX) | Accessory Kit No. | Critical Interchange Dimensions (Inches) | | | | | | | | LQ | |
|------------------------|----------------------------|-------------------|--|------|------|------|------|------|------|---------|---------|--|
| | | | AH | AJ | AK■ | BA | BB | BF | GA | 2-Stage | 3-Stage | |
| No Flange | 00 | N/A | | | | | | | | | | |
| Option 1 | F1 | G175701 | 1.41 | 3.94 | 3.15 | 4.72 | 0.12 | 0.28 | 0.39 | 7.42 | 8.19 | |
| Option 2 | F2 | G175702 | 1.41 | 4.53 | 3.74 | 5.51 | 0.12 | 0.35 | 0.39 | 7.42 | 8.19 | |
| Option 3 | F3 | G175703 | 1.41 | 5.12 | 4.33 | 6.30 | 0.14 | 0.35 | 0.39 | 7.42 | 8.19 | |
| Option 4 | F4 | G175704 | 1.41 | 6.54 | 5.12 | 7.87 | 0.14 | 0.43 | 0.43 | 7.42 | 8.19 | |

727 Series • Flange Mount • Mod-Squad Codes Accessory Kits

| Output Flange Options: | Mod-Squad Suffix Code (XX) | Accessory Kit No. | Critical Interchange Dimensions (Inches) | | | | | | | | LQ | |
|------------------------|----------------------------|-------------------|--|------|------|------|------|------|------|---------|---------|--|
| | | | AH | AJ | AK■ | BA | BB | BF | GA | 2-Stage | 3-Stage | |
| No Flange | 00 | N/A | | | | | | | | | | |
| Option 1 | F1 | G175701 | 1.79 | 3.94 | 3.15 | 4.72 | 0.12 | 0.28 | 0.39 | 7.44 | 8.21 | |
| Option 2 | F2 | G175702 | 1.79 | 4.53 | 3.74 | 5.51 | 0.12 | 0.35 | 0.39 | 7.44 | 8.21 | |
| Option 3 | F3 | G175703 | 1.79 | 5.12 | 4.33 | 6.30 | 0.14 | 0.35 | 0.39 | 7.44 | 8.21 | |
| Option 4 | F4 | G175704 | 1.79 | 6.54 | 5.12 | 7.87 | 0.14 | 0.43 | 0.43 | 7.44 | 8.21 | |

747 Series • Flange Mount • Mod-Squad Codes Accessory Kits

| Output Flange Options: | Mod-Squad Suffix Code (XX) | Accessory Kit No. | Critical Interchange Dimensions (Inches) | | | | | | | | | LQ1 |
|------------------------|----------------------------|-------------------|--|------|------|------|------|------|------|---------|---------|------|
| | | | AH | AJ | AK■ | BA | BB | BF | GA | 2-Stage | 3-Stage | LQ1 |
| No Flange | 00 | N/A | | | | | | | | | | |
| Option 1 | F1 | G175705 | 2.24 | 5.12 | 4.33 | 6.30 | 0.14 | 0.43 | 0.61 | 9.25 | 9.59 | 9.78 |
| Option 2 | F2 | G175706 | 2.30 | 6.46 | 5.12 | 7.87 | 0.14 | 0.43 | 0.51 | 9.19 | 9.53 | 9.72 |
| Option 3 | F3 | G175707 | 2.30 | 8.47 | 7.09 | 9.84 | 0.16 | 0.55 | 0.61 | 9.19 | 9.53 | 9.72 |

757 Series • Flange Mount • Mod-Squad Codes Accessory Kits

| Output Flange Options: | Mod-Squad Suffix Code (XX) | Accessory Kit No. | Critical Interchange Dimensions (Inches) | | | | | | | | | LQ1 |
|------------------------|----------------------------|-------------------|--|------|------|------|------|------|------|---------|---------|-------|
| | | | AH | AJ | AK■ | BA | BB | BF | GA | 2-Stage | 3-Stage | LQ1 |
| No Flange | 00 | N/A | | | | | | | | | | |
| Option 1 | F1 | G175705 | 2.60 | 5.12 | 4.33 | 6.30 | 0.14 | 0.43 | 0.61 | 10.00 | 10.35 | 10.53 |
| Option 2 | F2 | G175706 | 2.66 | 6.46 | 5.12 | 7.87 | 0.14 | 0.43 | 0.51 | 9.94 | 10.29 | 10.47 |
| Option 3 | F3 | G175707 | 2.66 | 8.47 | 7.09 | 9.84 | 0.16 | 0.55 | 0.61 | 9.94 | 10.29 | 10.47 |

■ Tolerance of AK on flanges with BA dimension under 6.30" is -0.0014 to -0.0028". Flanges with a BA of 6.30" or larger have a AK tolerance of -0.0017 to -0.0033".

Output Flange Mounting Dimensions

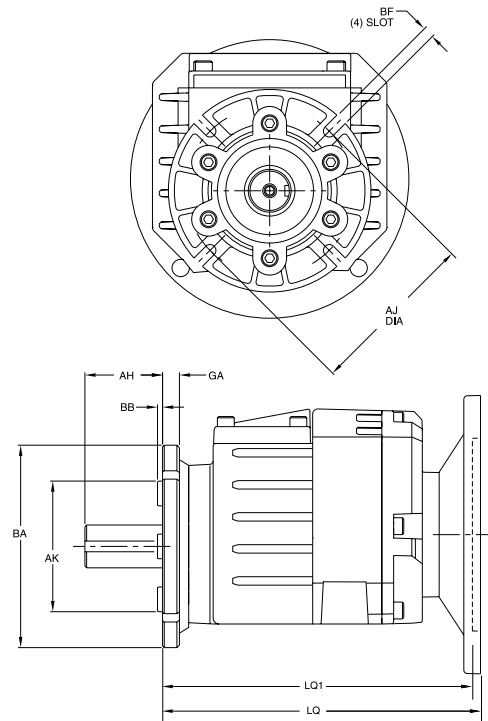

TORQUE FOOT SELECTIONS

The torque foot is available on base mounted reducers. The torque foot allows load transfer from bearing cage to foundation, including the external load capacity of the reducer. The torque foot should be considered where the application involves reversing loads or high shock loads to the system.

Torque Foot Mounting Dimensions (Inches)

| Series | Accessory Kit No. | T |
|--------|-------------------|------|
| 717 | G175708 | 0.20 |
| 727 | G175708 | 0.20 |
| 747 | G175709 | 0.25 |
| 757 | G175709 | 0.25 |

Note: Torque Foot is usable **only** on the B1 base mount.

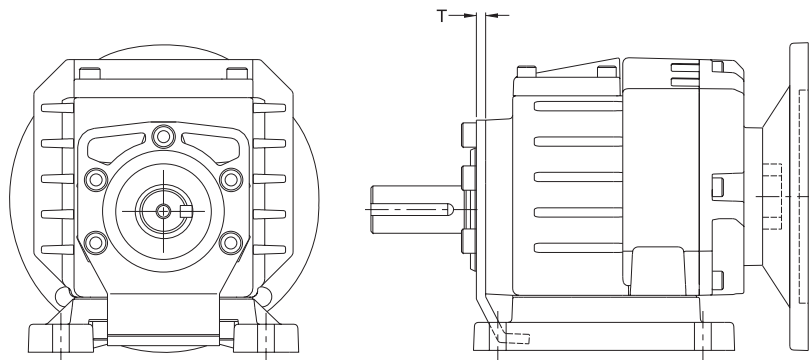

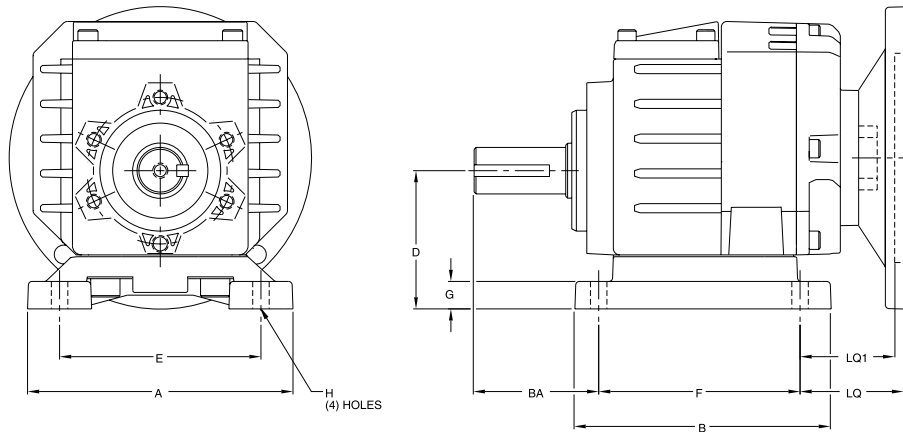

**Base Mounting Dimensions
Motorized Quill Input**

717 Series • Interchange Base Selections • Mod-Squad Codes • Accessory Kits

| Interchange With: | Mod-Squad Suffix Code (XX) | Accessory Kit No. | Critical Interchange Dimensions (Inches) | | | | | | | | | | LQ - 56C/140TC | | | |
|---------------------|----------------------------|-------------------|--|------|------|------|------|------|------|------|------|------|----------------|---------|--|--|
| | | | A | B | BA | BC | | D | E | F | G | H | 2-Stage | 3-Stage | | |
| No Base | 00 | N/A | | | | | | | | | | | | | | |
| SEW R17 | B1 | G175710 | 5.71 | 5.51 | 2.28 | 3.28 | 3.45 | 2.95 | 4.33 | 4.33 | 0.59 | 0.35 | 2.23 | 2.99 | | |
| SEW R32 | B1 | G175710 | 5.71 | 5.51 | 2.28 | 4.25 | 4.43 | 2.95 | 4.33 | 3.35 | 0.59 | 0.35 | 3.20 | 3.97 | | |
| Bonfiglioli C10 | B2** | G175711 | 5.71 | 5.51 | 2.28 | 4.17 | 4.35 | 3.35 | 4.33 | 3.43 | 0.99 | 0.35 | 3.12 | 3.89 | | |
| Brook Hansen SFN03B | B1 | G175710 | 5.71 | 5.51 | 2.28 | 3.28 | 3.45 | 2.95 | 4.33 | 3.35 | 0.59 | 0.35 | 2.23 | 2.99 | | |
| Browning CbN20 | B1 | G175710 | 5.71 | 5.51 | 2.28 | 3.28 | 3.45 | 2.95 | 4.33 | 3.35 | 0.59 | 0.35 | 2.23 | 2.99 | | |
| David Brown M03 | B1 | G175710 | 5.71 | 5.51 | 2.28 | 3.28 | 3.45 | 2.95 | 4.33 | 3.35 | 0.59 | 0.35 | 2.23 | 2.99 | | |
| Falk 03UC | B1 | G175710 | 5.71 | 5.51 | 2.28 | 3.28 | 3.45 | 2.95 | 4.33 | 3.35 | 0.59 | 0.35 | 2.23 | 2.99 | | |
| Grove 2032/3 | B1 | G175710 | 5.71 | 5.51 | 2.28 | 3.28 | 3.45 | 2.95 | 4.33 | 3.35 | 0.59 | 0.35 | 2.23 | 2.99 | | |
| Hansen 0 | B1 | G175710 | 5.71 | 5.51 | 2.28 | 3.28 | 3.45 | 2.95 | 4.33 | 3.35 | 0.59 | 0.35 | 2.23 | 2.99 | | |
| Lenze 4 | B3 | G175712 | 5.67 | 4.41 | 2.01 | 4.88 | 5.06 | 3.15 | 4.13 | 2.99 | 0.40 | 0.35 | 3.83 | 4.60 | | |
| Leroy Somer NXT N20 | B1 | G175710 | 5.71 | 5.51 | 2.28 | 3.28 | 3.45 | 2.95 | 4.33 | 3.35 | 0.59 | 0.35 | 2.23 | 2.99 | | |
| Motovario 032/3 | B1 | G175710 | 5.71 | 5.51 | 2.28 | 3.28 | 3.45 | 2.95 | 4.33 | 3.15 | 0.59 | 0.35 | 2.23 | 2.99 | | |
| Nord SK02 | B4 | G175713 | 5.67 | 4.41 | 1.97 | 5.55 | 5.73 | 3.39 | 4.33 | 2.36 | 0.64 | 0.35 | 4.50 | 5.27 | | |
| Nord SK172 | B1 | G175710 | 5.71 | 5.51 | 2.28 | 3.28 | 3.45 | 2.95 | 4.33 | 4.33 | 0.59 | 0.35 | 2.23 | 2.99 | | |
| Stober C002/3 | B5 | G175714 | 5.67 | 4.41 | 2.17 | 5.27 | 5.45 | 3.23 | 4.33 | 2.44 | 0.48 | 0.28 | 4.22 | 4.99 | | |
| Sumitomo 4085 | B6 | G175715 | 5.67 | 4.41 | 1.85 | 5.67 | 5.85 | 3.15 | 4.72 | 2.36 | 0.40 | 0.35 | 4.62 | 5.39 | | |

727 Series • Interchange Base Selections • Mod-Squad Codes • Accessory Kits

| Interchange With: | Mod-Squad Suffix Code (XX) | Accessory Kit No. | Critical Interchange Dimensions (Inches) | | | | | | | | | | LQ - 56C/140TC | | | |
|---------------------|----------------------------|-------------------|--|------|------|------|------|------|------|------|------|------|----------------|---------|--|--|
| | | | A | B | BA | BC | | D | E | F | G | H | 2-Stage | 3-Stage | | |
| No Base | 00 | N/A | | | | | | | | | | | | | | |
| SEW R27 | B1 | G175717 | 5.71 | 6.02 | 2.95 | 2.20 | 2.38 | 3.54 | 4.33 | 5.12 | 0.79 | 0.35 | 1.15 | 2.99 | | |
| SEW R37 | B1 | G175717 | 5.71 | 6.02 | 2.95 | 2.20 | 2.38 | 3.54 | 4.33 | 5.12 | 0.79 | 0.35 | 1.15 | 2.99 | | |
| SEW R40 | B1 | G175717 | 5.71 | 6.02 | 2.95 | 2.20 | 2.38 | 3.54 | 4.33 | 5.12 | 0.79 | 0.35 | 1.15 | 2.99 | | |
| Bonfiglioli C20 | B2 | G175718 | 6.10 | 5.35 | 2.68 | 3.35 | 3.53 | 3.94 | 5.12 | 4.23 | 0.67 | 0.43 | 2.32 | 3.09 | | |
| Brook Hansen SFN15B | B1 | G175717 | 5.71 | 6.02 | 2.95 | 2.20 | 2.38 | 3.54 | 4.33 | 5.12 | 0.79 | 0.35 | 1.15 | 2.99 | | |
| Browning CbN21 | B3 | G175719 | 5.31 | 6.12 | 2.63 | 1.13 | 1.31 | 3.15 | 4.33 | 6.50 | 0.62 | 0.35 | 0.10 | 0.87 | | |
| David Brown M04 | B1 | G175717 | 5.71 | 6.02 | 2.95 | 2.20 | 2.38 | 3.54 | 4.33 | 5.12 | 0.79 | 0.35 | 1.15 | 2.99 | | |
| Dodge Quantis HB38 | B1 | G175717 | 5.71 | 6.02 | 2.95 | 2.20 | 2.38 | 3.54 | 4.33 | 5.12 | 0.79 | 0.35 | 1.15 | 2.99 | | |
| Falk 04UC | B1 | G175717 | 5.71 | 6.02 | 2.95 | 2.20 | 2.38 | 3.54 | 4.33 | 5.12 | 0.79 | 0.35 | 1.15 | 2.99 | | |
| Flender/ Motox D30 | B1 | G175717 | 5.71 | 6.02 | 2.95 | 2.20 | 2.38 | 3.54 | 4.33 | 5.12 | 0.79 | 0.35 | 1.15 | 2.99 | | |
| Grove 2042/3 | B1 | G175717 | 5.71 | 6.02 | 2.95 | 2.20 | 2.38 | 3.54 | 4.33 | 5.12 | 0.79 | 0.35 | 1.15 | 2.99 | | |
| Hansen 1 | B3 | G175719 | 5.31 | 6.12 | 2.63 | 1.13 | 1.31 | 3.15 | 4.33 | 6.50 | 0.62 | 0.35 | 0.10 | 0.87 | | |
| Lenze 5 | B4 | G175720 | 7.09 | 5.47 | 2.63 | 4.09 | 4.27 | 3.94 | 4.92 | 3.54 | 0.66 | 0.43 | 3.06 | 3.83 | | |
| Leroy Somer NXT N21 | B3 | G175719 | 5.31 | 6.12 | 2.63 | 1.13 | 1.31 | 3.15 | 4.33 | 6.50 | 0.62 | 0.35 | 0.10 | 0.87 | | |
| Motovario 042/3 | B5 | G175721 | 5.71 | 5.08 | 2.95 | 3.96 | 4.14 | 3.15 | 4.33 | 3.35 | 0.59 | 0.35 | 2.93 | 3.70 | | |
| Nord SK12 | B6 | G175722 | 5.31 | 5.47 | 3.23 | 4.59 | 4.77 | 4.02 | 4.13 | 2.44 | 1.49 | 0.35 | 3.56 | 4.33 | | |
| Nord SK272 | B1 | G175717 | 5.71 | 5.98 | 2.95 | 2.20 | 2.38 | 3.54 | 4.33 | 5.12 | 0.71 | 0.35 | 1.15 | 2.99 | | |
| Stober C102/3 | B7 | G175723 | 7.09 | 5.47 | 2.64 | 4.86 | 5.04 | 4.02 | 5.91 | 2.76 | 0.74 | 0.35 | 3.83 | 4.60 | | |
| Sumitomo 4097 | B8 | G175724 | 7.09 | 5.47 | 2.36 | 4.36 | 4.54 | 3.94 | 5.90 | 3.54 | 0.66 | 0.43 | 3.33 | 4.10 | | |

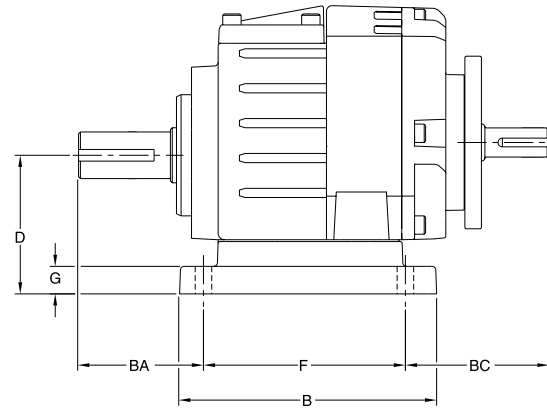
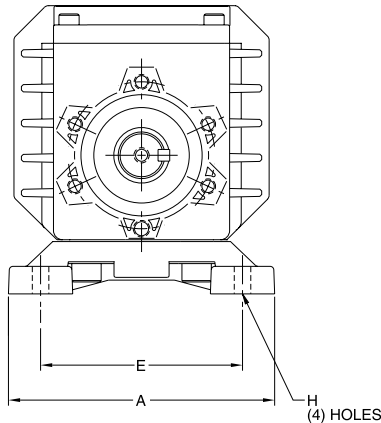

Base Mounting Dimensions
Non-Motorized Input

747 Series • Interchange Base Selections • Mod-Squad Codes • Accessory Kits

| Interchange With: | Mod-Squad Suffix Code (XX) | Accessory Kit No. | Critical Interchange Dimensions (Inches) | | | | | | | | | | LQ - 56C/140TC | | LQ1 180TC | | |
|---------------------|----------------------------|-------------------|--|------|------|------|------|------|------|------|------|------|----------------|---------|-----------|--|--|
| | | | A | B | BA | BC | | D | E | F | G | H | 2-Stage | 3-Stage | | | |
| No Base | 00 | N/A | | | | | | | | | | | | | | | |
| SEW R47 | B1 | G175725 | 6.69 | 7.76 | 3.54 | 2.96 | 2.88 | 4.53 | 5.31 | 6.50 | 0.94 | 0.55 | 1.45 | 1.83 | 1.98 | | |
| SEW R60 | B1 | G175725 | 6.69 | 7.76 | 3.54 | 2.96 | 2.88 | 4.53 | 5.31 | 6.50 | 0.94 | 0.55 | 1.45 | 1.83 | 1.98 | | |
| Bonfiglioli C30 | B2 | G175726 | 7.48 | 6.14 | 3.07 | 4.83 | 4.75 | 4.33 | 6.30 | 5.10 | 0.79 | 0.43 | 3.32 | 3.66 | 3.85 | | |
| Brook Hansen SFN25B | B1 | G175725 | 6.69 | 7.76 | 3.54 | 2.96 | 2.88 | 4.53 | 5.31 | 6.50 | 0.94 | 0.55 | 1.45 | 1.83 | 1.98 | | |
| Browning CbN22 | B3 | G175727 | 7.52 | 8.58 | 3.01 | 2.43 | 2.35 | 3.94 | 5.31 | 7.56 | 0.75 | 0.55 | 0.92 | 1.26 | 1.45 | | |
| David Brown M06 | B1 | G175725 | 6.69 | 7.76 | 3.54 | 2.96 | 2.88 | 4.53 | 5.31 | 6.50 | 0.94 | 0.55 | 1.45 | 1.83 | 1.98 | | |
| Dodge Quantis HB48 | B1 | G175725 | 6.69 | 7.76 | 3.54 | 2.96 | 2.88 | 4.53 | 5.31 | 6.50 | 0.94 | 0.55 | 1.45 | 1.83 | 1.98 | | |
| Falk 06UC | B1 | G175725 | 6.69 | 7.76 | 3.54 | 2.96 | 2.88 | 4.53 | 5.31 | 6.50 | 0.94 | 0.55 | 1.45 | 1.83 | 1.98 | | |
| Flender/ Motox D40 | B1 | G175725 | 6.69 | 7.76 | 3.54 | 2.96 | 2.88 | 4.53 | 5.31 | 6.50 | 0.94 | 0.55 | 1.45 | 1.83 | 1.98 | | |
| Grove 2062 | B1 | G175725 | 6.69 | 7.76 | 3.54 | 2.96 | 2.88 | 4.53 | 5.31 | 6.50 | 0.94 | 0.55 | 1.45 | 1.83 | 1.98 | | |
| Hansen 2 | B3 | G175727 | 7.52 | 8.58 | 3.01 | 2.43 | 2.35 | 3.94 | 5.31 | 7.56 | 0.75 | 0.55 | 0.92 | 1.26 | 1.45 | | |
| Lenze 6 | B4 | G175728 | 7.87 | 6.59 | 3.25 | 5.58 | 5.50 | 4.92 | 6.30 | 4.17 | 0.92 | 0.53 | 4.07 | 4.41 | 4.60 | | |
| Leroy Somer NXT N22 | B3 | G175727 | 7.52 | 8.58 | 3.01 | 2.43 | 2.35 | 3.94 | 5.31 | 7.56 | 0.75 | 0.55 | 0.92 | 1.26 | 1.45 | | |
| Motovario 052 | B5 | G175729 | 7.48 | 5.51 | 3.54 | 5.52 | 5.44 | 3.54 | 5.31 | 3.94 | 0.71 | 0.43 | 4.01 | 4.35 | 4.54 | | |
| Nord SK22 | B6 | G175730 | 7.87 | 6.59 | 3.30 | 6.55 | 6.47 | 4.92 | 6.30 | 3.15 | 0.92 | 0.43 | 5.04 | 5.38 | 5.57 | | |
| Nord SK472 | B1 | G175725 | 6.69 | 7.76 | 3.54 | 2.96 | 2.88 | 4.53 | 5.31 | 6.50 | 0.94 | 0.55 | 1.45 | 1.83 | 1.98 | | |
| Stober C202 | B7 | G175731 | 7.87 | 6.59 | 3.11 | 6.54 | 6.46 | 4.53 | 6.69 | 3.35 | 0.53 | 0.43 | 5.03 | 5.37 | 5.56 | | |

757 Series • Interchange Base Selections • Mod-Squad Codes • Accessory Kits

| Interchange With: | Mod-Squad Suffix Code (XX) | Accessory Kit No. | Critical Interchange Dimensions (Inches) | | | | | | | | | | LQ - 56C/140TC | | LQ1 180TC | | |
|---------------------|----------------------------|-------------------|--|------|------|------|------|------|------|------|------|------|----------------|---------|-----------|--|--|
| | | | A | B | BA | BC | | D | E | F | G | H | 2-Stage | 3-Stage | | | |
| No Base | 00 | N/A | | | | | | | | | | | | | | | |
| SEW R57 | B1** | G175732 | 6.69 | 7.76 | 3.94 | 3.63 | 3.56 | 4.53 | 5.31 | 6.50 | 0.94 | 0.55 | 2.16 | 2.51 | 2.69 | | |
| SEW R60 | B1 | G175732 | 6.69 | 7.76 | 3.54 | 3.63 | 3.56 | 4.53 | 5.31 | 6.50 | 0.94 | 0.55 | 2.16 | 2.51 | 2.69 | | |
| Bonfiglioli C30 | B2 | G175733 | 7.48 | 6.14 | 3.07 | 5.90 | 5.97 | 4.33 | 6.30 | 5.10 | 0.79 | 0.43 | 4.43 | 4.78 | 4.96 | | |
| Bonfiglioli C40 | B9 | G175740 | 8.50 | 7.30 | 3.54 | 4.64 | 4.71 | 5.12 | 7.09 | 5.89 | 0.71 | 0.55 | 3.17 | 3.52 | 3.70 | | |
| Brook Hansen SFN25B | B1 | G175732 | 6.69 | 7.76 | 3.54 | 3.63 | 3.56 | 4.53 | 5.31 | 6.50 | 0.94 | 0.55 | 2.16 | 2.51 | 2.69 | | |
| Browning CbN22 | B3 | G175734 | 7.52 | 8.58 | 3.01 | 3.50 | 3.57 | 3.94 | 5.31 | 7.56 | 0.75 | 0.55 | 2.03 | 2.38 | 2.56 | | |
| David Brown M06 | B1 | G175732 | 6.69 | 7.76 | 3.54 | 3.63 | 3.56 | 4.53 | 5.31 | 6.50 | 0.94 | 0.55 | 2.16 | 2.51 | 2.69 | | |
| Dodge Quantis HB48 | B1 | G175732 | 6.69 | 7.76 | 3.54 | 3.63 | 3.56 | 4.53 | 5.31 | 6.50 | 0.94 | 0.55 | 2.16 | 2.51 | 2.69 | | |
| Falk 06UC | B1 | G175732 | 6.69 | 7.76 | 3.54 | 3.63 | 3.56 | 4.53 | 5.31 | 6.50 | 0.94 | 0.55 | 2.16 | 2.51 | 2.69 | | |
| Flender/ Motox D40 | B1 | G175732 | 6.69 | 7.76 | 3.54 | 3.63 | 3.56 | 4.53 | 5.31 | 6.50 | 0.94 | 0.55 | 2.16 | 2.51 | 2.69 | | |
| Grove 2062 | B1 | G175732 | 6.69 | 7.76 | 3.54 | 3.63 | 3.56 | 4.53 | 5.31 | 6.50 | 0.94 | 0.55 | 2.16 | 2.51 | 2.69 | | |
| Hansen 2 | B3 | G175734 | 7.52 | 8.58 | 3.01 | 3.50 | 3.57 | 3.94 | 5.31 | 7.56 | 0.75 | 0.55 | 2.03 | 2.38 | 2.56 | | |
| Lenze 6 | B4 | G175735 | 7.87 | 6.59 | 3.25 | 6.65 | 6.72 | 4.92 | 6.30 | 4.17 | 0.92 | 0.53 | 5.18 | 5.53 | 5.71 | | |
| Leroy Somer NXT N22 | B3 | G175734 | 7.52 | 8.58 | 3.01 | 3.50 | 3.57 | 3.94 | 5.31 | 7.56 | 0.75 | 0.55 | 2.03 | 2.38 | 2.56 | | |
| Motovario 052 | B5 | G175736 | 7.48 | 5.51 | 3.54 | 6.59 | 6.66 | 3.54 | 5.31 | 3.94 | 0.71 | 0.43 | 5.12 | 5.47 | 5.65 | | |
| Nord SK22 | B6 | G175737 | 7.97 | 6.59 | 3.30 | 7.62 | 7.69 | 4.92 | 6.30 | 3.15 | 0.92 | 0.43 | 6.15 | 6.50 | 6.68 | | |
| Nord SK572 | B1** | G175732 | 6.69 | 7.76 | 3.94 | 3.63 | 3.56 | 4.53 | 5.31 | 6.50 | 0.94 | 0.55 | 2.16 | 2.51 | 2.69 | | |
| Stober C202 | B7 | G175738 | 7.87 | 6.59 | 3.11 | 7.61 | 7.68 | 4.53 | 6.69 | 3.35 | 0.53 | 0.43 | 6.14 | 6.49 | 6.67 | | |

** Requires optional 1.375" diameter shaft to obtain stated BA dimension. Contact LEESON for availability.